

LEGEND

- Touchscreen control
- Ceiling support & hanger
- Ceiling access panel

**C-CHANNEL DESIGNATION:

NORTH & SOUTH =	C8 x 11.5
AMERICA	[C200 x 17]
EUROPE =	C200 x 75
ASIA =	C200 x 80

NOTE:
C-CHANNEL IS
INSTALLED WITH
FLANGES UP.

NOTE: ALL SUPPORT STEEL IS BY OTHERS.

PRELIMINARY:

THIS DRAWING IS INTENDED AS A GUIDE. IN ALL CASES SKYFOLD SHOP DRAWINGS SPECIFIC TO EACH PROJECT ARE REQUIRED FOR FINAL BUILD-TO DIMENSIONS.



TYPICAL EVEN SKYFOLD WALL
Standard drive unit

PLAN

drawing no. **S7734-1** RO scale **N.T.S.**

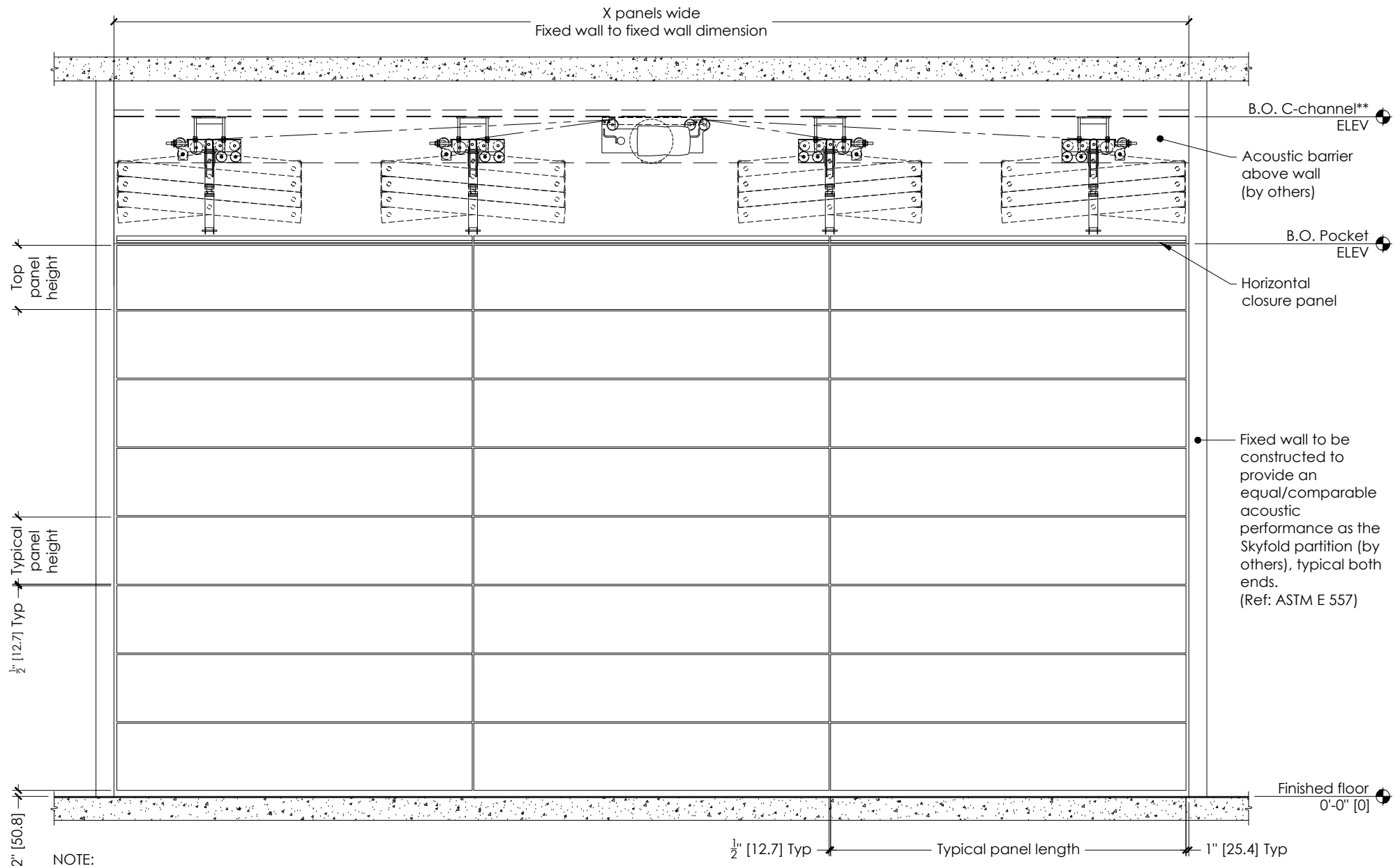

NOTE:
 PLANCHER FINI $\pm 1/4"$ [± 6 mm] DE LA SURFACE PLANE
 MUR FIXE $+1/4"$ / $-0"$ [$+6$ mm / -0 mm] DE LA VERTICALE PLATE

TOUT SUPPORT EN ACIER EST PAR TIERS.

PRÉLIMINAIRE:

CE DESSIN EST DESTINÉ À SERVIR DE GUIDE. DANS TOUS LES CAS, LES DESSINS D'ATELIER DE SKYFOLD, SPÉCIFIQUES À CHAQUE PROJET, SONT NÉCESSAIRES POUR LES DIMENSIONS DE FABRICATION.

** DÉSIGNATION POUR LES PROFILÉS EN "C":

AMÉRIQUE DU NORD = C8 x 11.5
 ET DU SUD [C200 x 17]

EUROPE = C200 x 75

ASIE = C200 x 80

NOTE:
 LE PROFILÉ EN "C" EST
 INSTALLÉ AVEC
 LES BRIDES
 VERS LE HAUT.



SKYFOLD
 SÉRIE CLASSIC™ PREMIUM

CLOISON SKYFOLD TYPIQUE PAIR
 Unité d'entraînement standard

ÉLÉVATION

no. dessin

S7734-2 R0 AUCUNE

échelle

© SKYFOLD INC.

Standard motor unit & ceiling supports to be attached to C-channel** before construction of acoustic barrier & pocket.

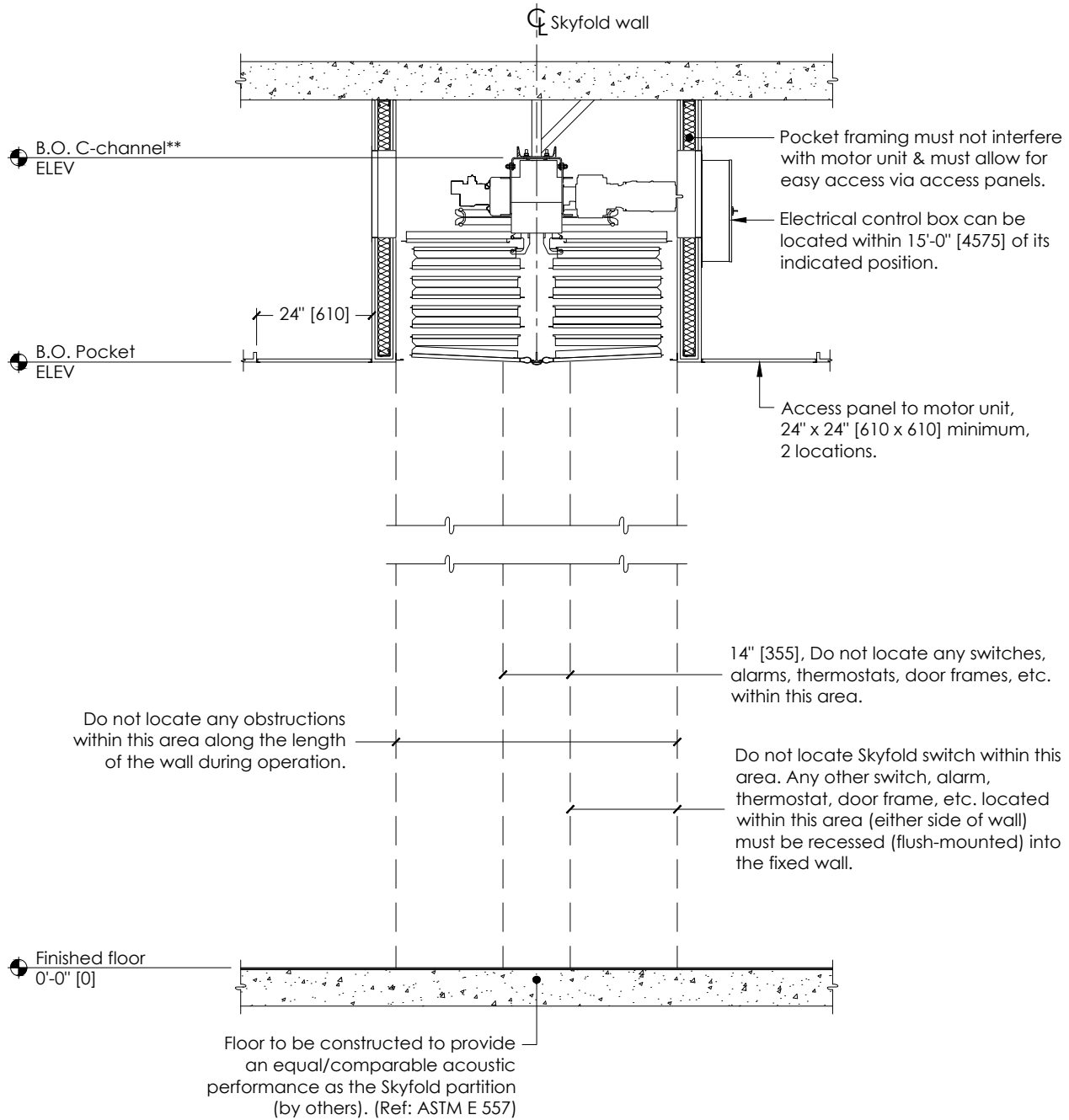

****C-CHANNEL DESIGNATION:**

NORTH & SOUTH = C8 x 11.5
AMERICA [C200 x 17]
EUROPE = C200 x 75
ASIA = C200 x 80

NOTE:
C-CHANNEL IS
INSTALLED WITH
FLANGES UP.



NOTE: ALL SUPPORT STEEL IS BY OTHERS.

PRELIMINARY:

THIS DRAWING IS INTENDED AS A GUIDE. IN ALL CASES SKYFOLD SHOP DRAWINGS SPECIFIC TO EACH PROJECT ARE REQUIRED FOR FINAL BUILD-TO DIMENSIONS.



TYPICAL EVEN SKYFOLD WALL
Standard drive unit

SECTION: WALL UP

drawing no.

S7734-3 RO

scale

N.T.S.

© SKYFOLD INC.

Standard motor unit & ceiling supports to be attached to C-channel** before construction of acoustic barrier & pocket.

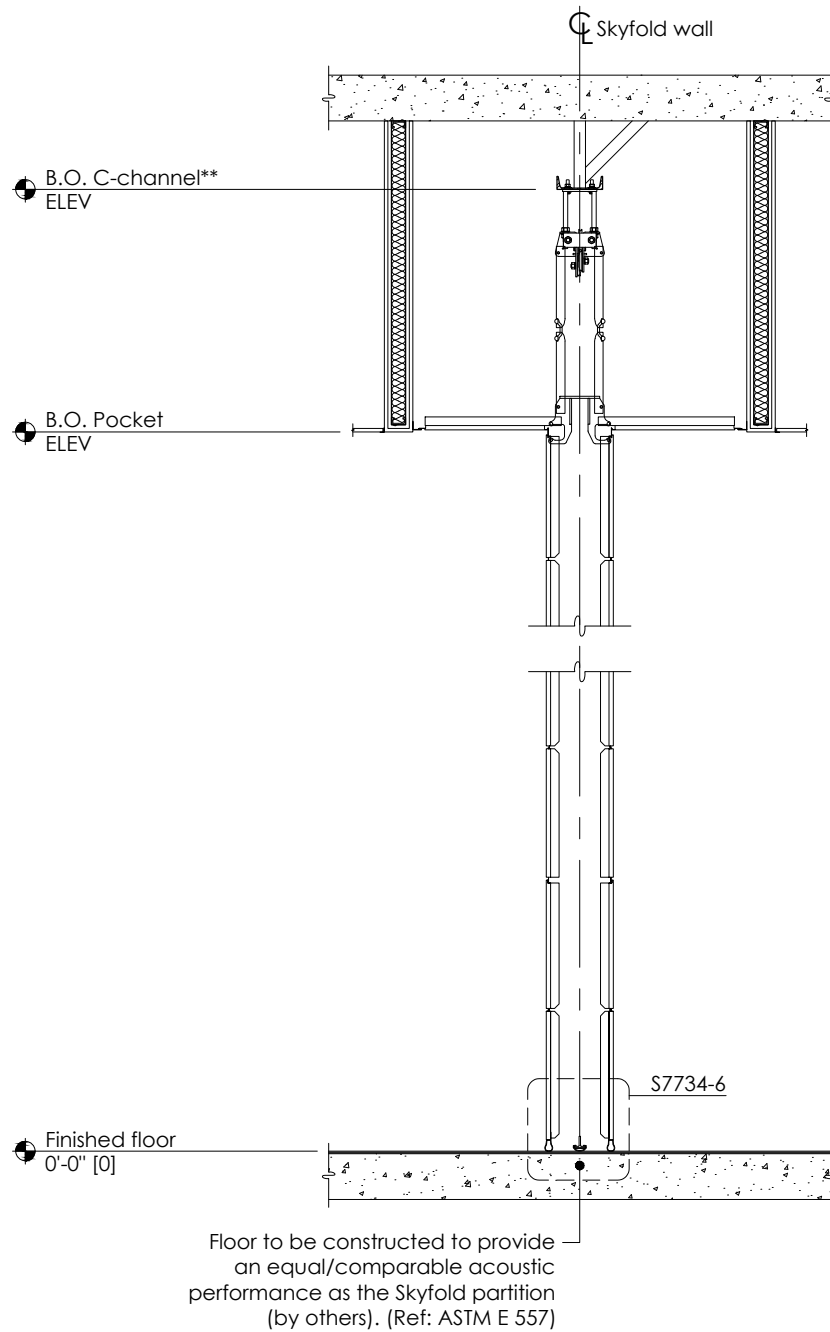

****C-CHANNEL DESIGNATION:**

NORTH & SOUTH = C8 x 11.5
AMERICA [C200 x 17]
EUROPE = C200 x 75
ASIA = C200 x 80

NOTE:
C-CHANNEL IS
INSTALLED WITH
FLANGES UP.



NOTE: ALL SUPPORT STEEL IS BY OTHERS.

PRELIMINARY:

THIS DRAWING IS INTENDED AS A GUIDE. IN ALL CASES SKYFOLD SHOP DRAWINGS SPECIFIC TO EACH PROJECT ARE REQUIRED FOR FINAL BUILD-TO DIMENSIONS.

SKYFOLD®
CLASSIC™ PREMIUM SERIES

TYPICAL EVEN SKYFOLD WALL
Standard drive unit

SECTION: WALL DOWN

drawing no.

S7734-4 RO

scale

N.T.S.

© SKYFOLD INC.

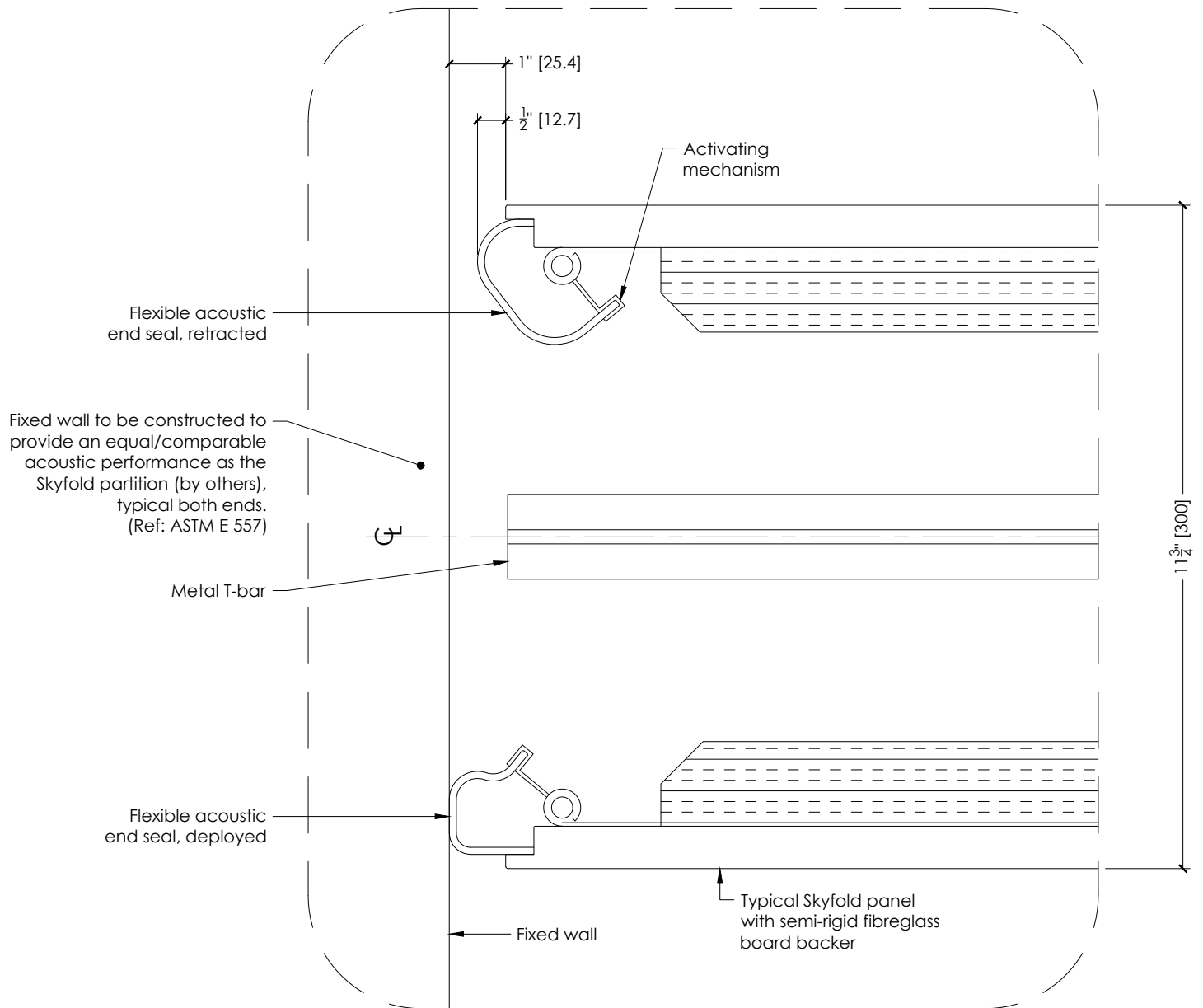

PRELIMINARY:

THIS DRAWING IS INTENDED AS A GUIDE. IN ALL CASES SKYFOLD SHOP DRAWINGS SPECIFIC TO EACH PROJECT ARE REQUIRED FOR FINAL BUILD-TO DIMENSIONS.

SKYFOLD®
CLASSIC™ PREMIUM SERIES

TYPICAL EVEN SKYFOLD WALL
Standard drive unit

END SEAL DETAIL

drawing no.

S7734-5 RO

scale

N.T.S.

© SKYFOLD INC.

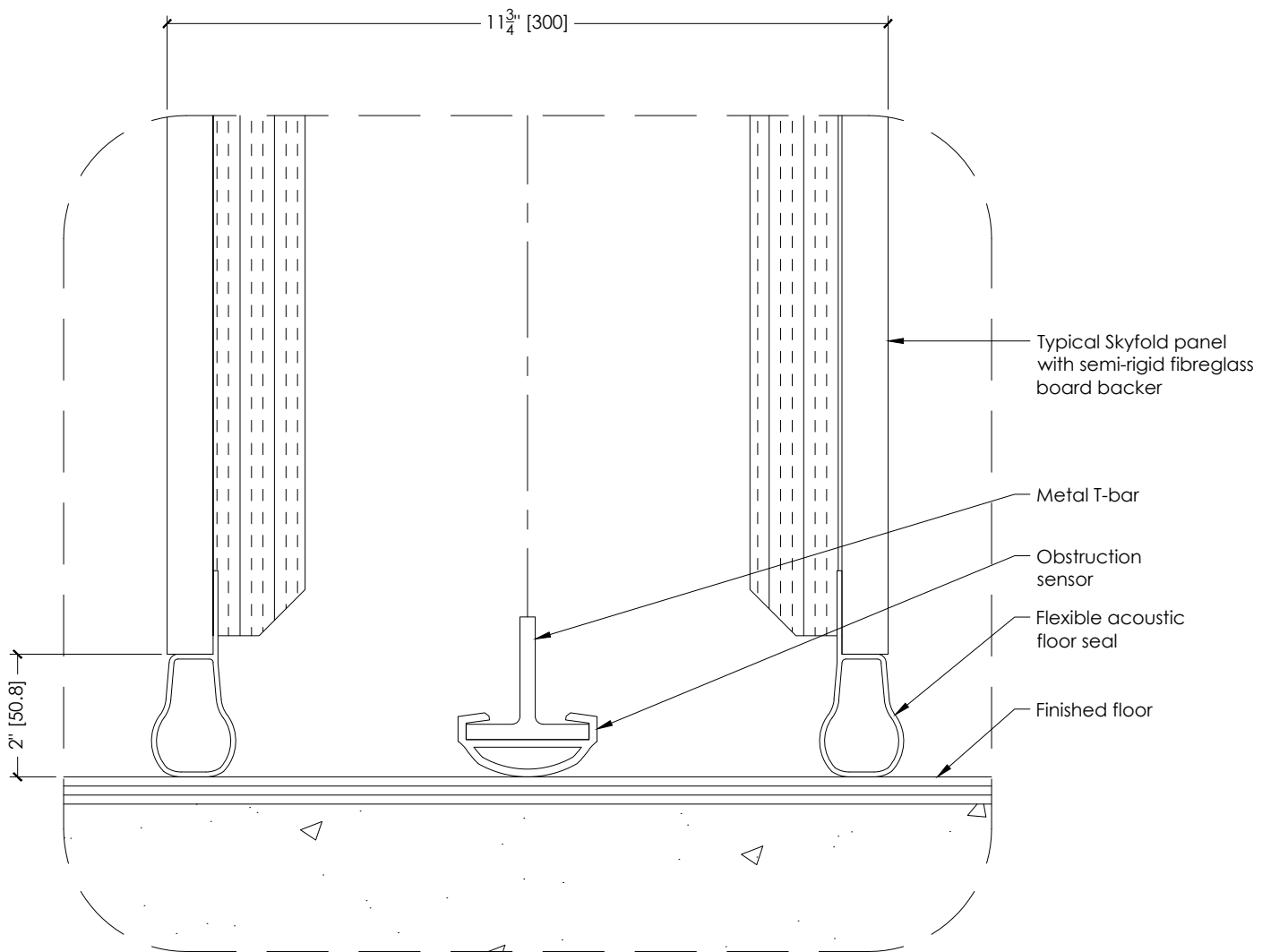

PRELIMINARY:

THIS DRAWING IS INTENDED AS A GUIDE. IN ALL CASES SKYFOLD SHOP DRAWINGS SPECIFIC TO EACH PROJECT ARE REQUIRED FOR FINAL BUILD-TO DIMENSIONS.

SKYFOLD®
CLASSIC™ PREMIUM SERIES

TYPICAL EVEN SKYFOLD WALL
Standard drive unit

FLOOR SEAL DETAIL

drawing no.

S7734-6 RO

scale

N.T.S.

© SKYFOLD INC.