

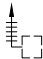

LEGEND

-  Touchscreen control
-  Ceiling support & hanger
-  Ceiling access panel

**C-CHANNEL DESIGNATION:

NORTH & SOUTH =	C8 x 11.5
AMERICA	[C200 x 17]
EUROPE =	C200 x 75
ASIA =	C200 x 80

NOTE:
C-CHANNEL IS
INSTALLED WITH
FLANGES UP.

NOTE: ALL SUPPORT STEEL IS BY OTHERS.

PRELIMINARY:

THIS DRAWING IS INTENDED AS A GUIDE. IN ALL CASES SKYFOLD SHOP DRAWINGS SPECIFIC TO EACH PROJECT ARE REQUIRED FOR FINAL BUILD-TO DIMENSIONS.



TYPICAL EVEN SKYFOLD WALL
Standard drive unit

PLAN

drawing no. **S7734-1** RO scale **N.T.S.**

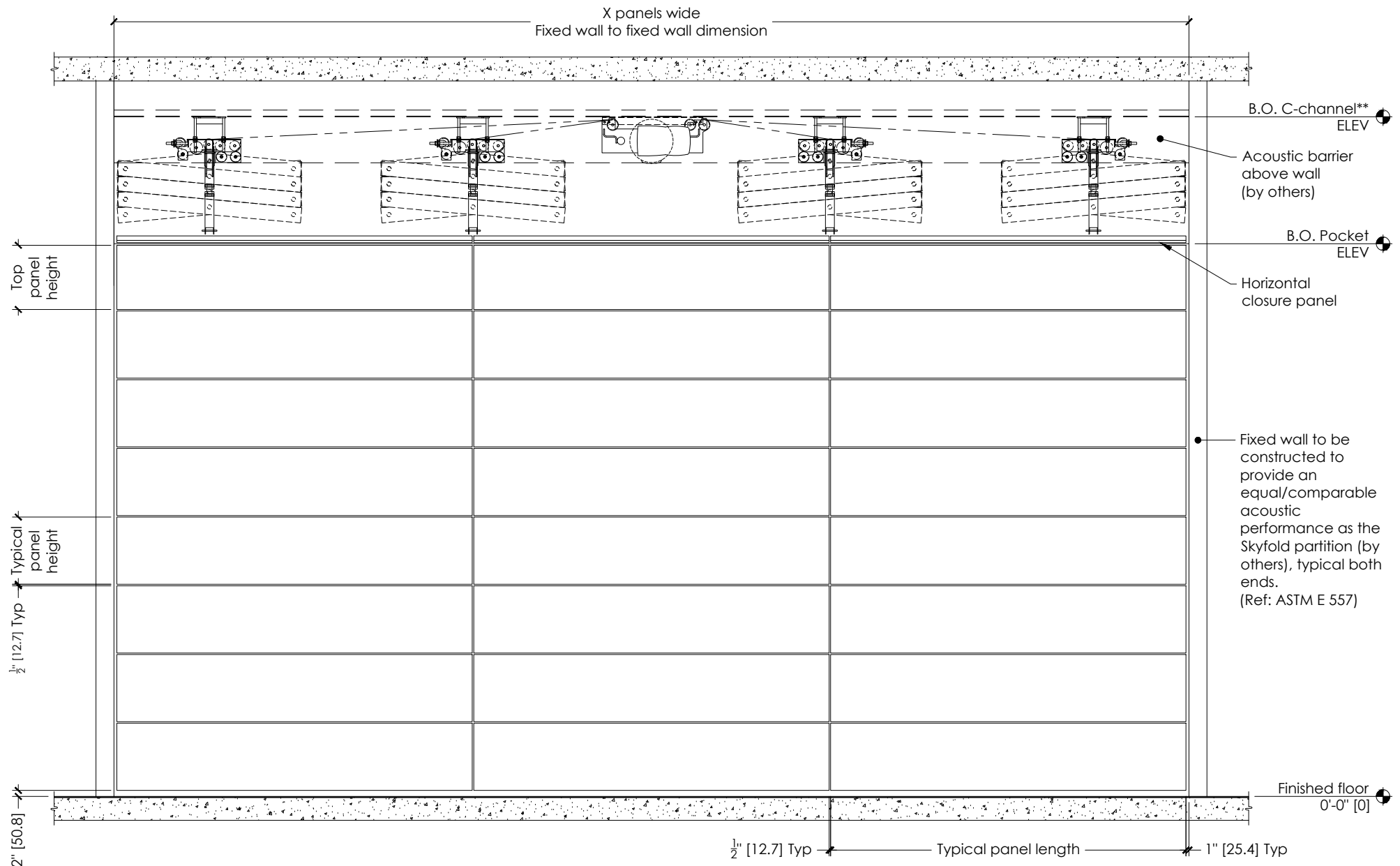

NOTE:
FINISHED FLOOR $\pm 1/4"$ [± 6 mm] FROM FLAT LEVEL
FIXED WALL $+1/4"$ / $-0"$ [$+6$ mm / -0 mm] FROM PLUMB VERTICAL

ALL SUPPORT STEEL IS BY OTHERS.

PRELIMINARY:

THIS DRAWING IS INTENDED AS A GUIDE. IN ALL CASES
SKYFOLD SHOP DRAWINGS SPECIFIC TO EACH PROJECT
ARE REQUIRED FOR FINAL BUILD-TO DIMENSIONS.

****C-CHANNEL DESIGNATION:**

NORTH & SOUTH = C8 x 11.5
AMERICA [C200 x 17]
EUROPE = C200 x 75
ASIA = C200 x 80

NOTE:
C-CHANNEL IS
INSTALLED WITH
FLANGES UP.



SKYFOLD®
CLASSIC™ PREMIUM SERIES

TYPICAL EVEN SKYFOLD WALL
Standard drive unit

ELEVATION

drawing no. **S7734-2** RO scale **N.T.S.**

Standard motor unit & ceiling supports to be attached to C-channel** before construction of acoustic barrier & pocket.

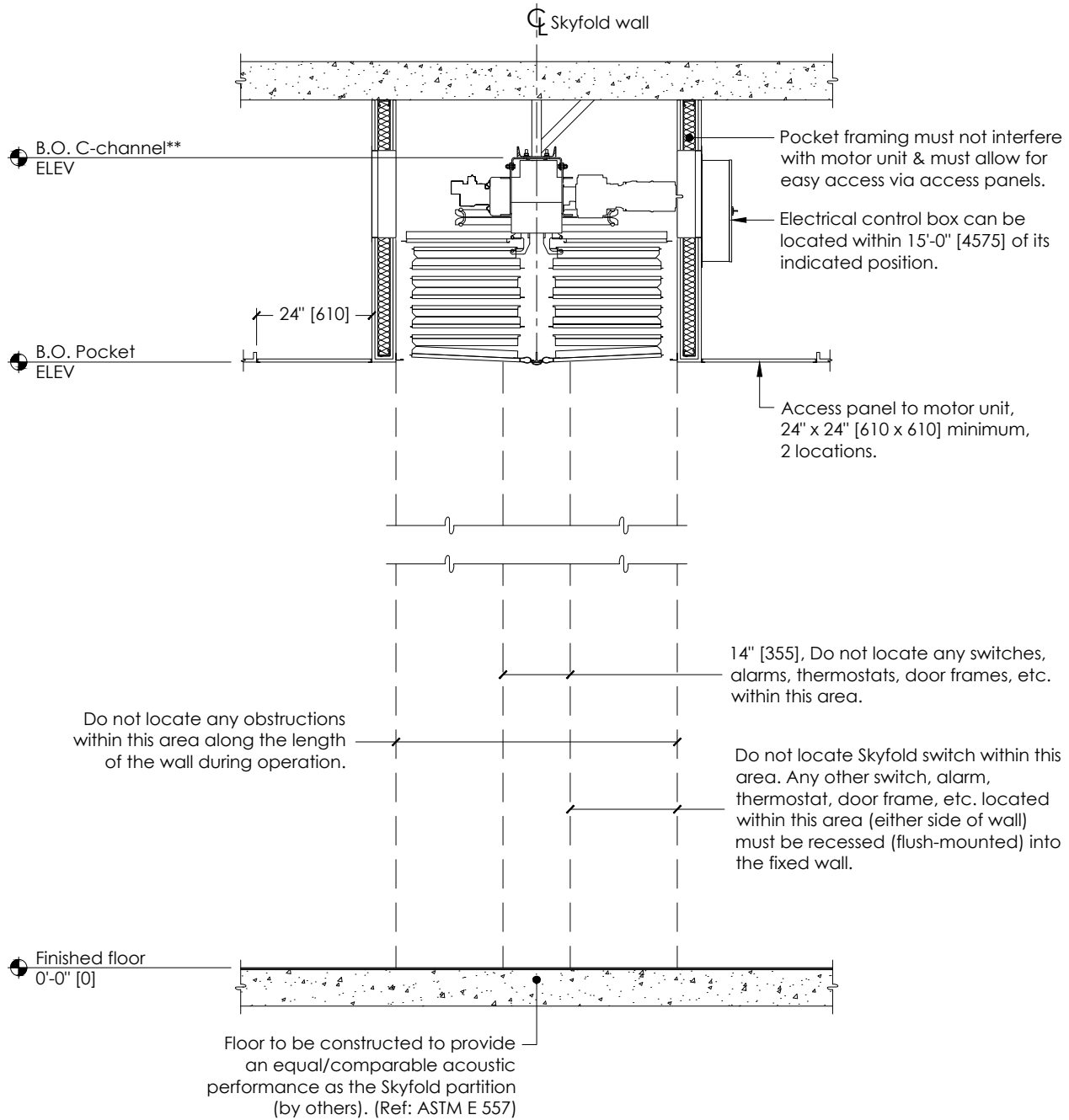

****C-CHANNEL DESIGNATION:**

NORTH & SOUTH = C8 x 11.5
AMERICA [C200 x 17]
EUROPE = C200 x 75
ASIA = C200 x 80

NOTE:
C-CHANNEL IS
INSTALLED WITH
FLANGES UP.



NOTE: ALL SUPPORT STEEL IS BY OTHERS.

PRELIMINARY:

THIS DRAWING IS INTENDED AS A GUIDE. IN ALL CASES SKYFOLD SHOP DRAWINGS SPECIFIC TO EACH PROJECT ARE REQUIRED FOR FINAL BUILD-TO DIMENSIONS.

SKYFOLD®
CLASSIC™ PREMIUM SERIES

TYPICAL EVEN SKYFOLD WALL
Standard drive unit

SECTION: WALL UP

drawing no.

S7734-3 RO

scale

N.T.S.

© SKYFOLD INC.

Standard motor unit & ceiling supports to be attached to C-channel** before construction of acoustic barrier & pocket.

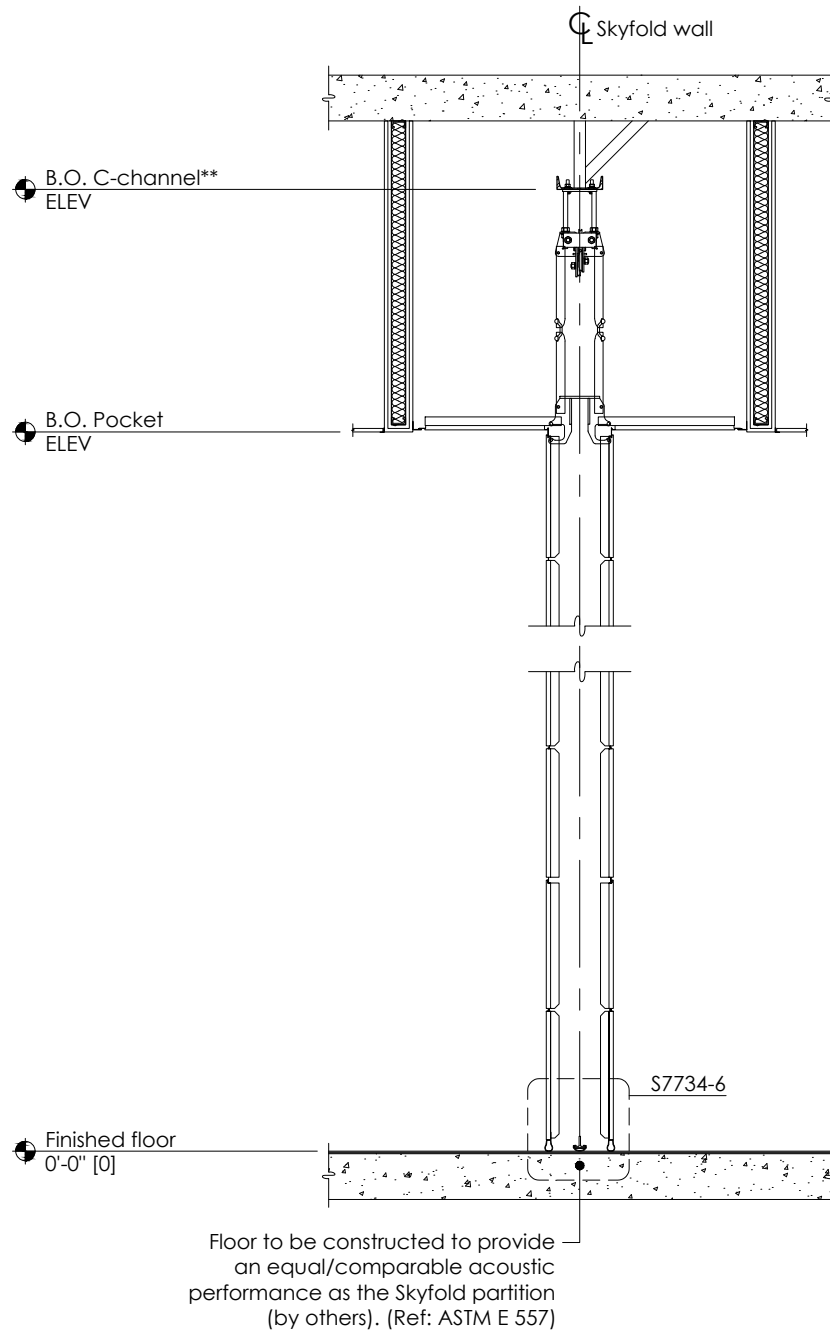

****C-CHANNEL DESIGNATION:**

NORTH & SOUTH = C8 x 11.5
AMERICA [C200 x 17]
EUROPE = C200 x 75
ASIA = C200 x 80

NOTE:
C-CHANNEL IS
INSTALLED WITH
FLANGES UP.



NOTE: ALL SUPPORT STEEL IS BY OTHERS.

PRELIMINARY:

THIS DRAWING IS INTENDED AS A GUIDE. IN ALL CASES SKYFOLD SHOP DRAWINGS SPECIFIC TO EACH PROJECT ARE REQUIRED FOR FINAL BUILD-TO DIMENSIONS.

SKYFOLD®
CLASSIC™ PREMIUM SERIES

TYPICAL EVEN SKYFOLD WALL
Standard drive unit

SECTION: WALL DOWN

drawing no. **S7734-4 RO** scale **N.T.S.**

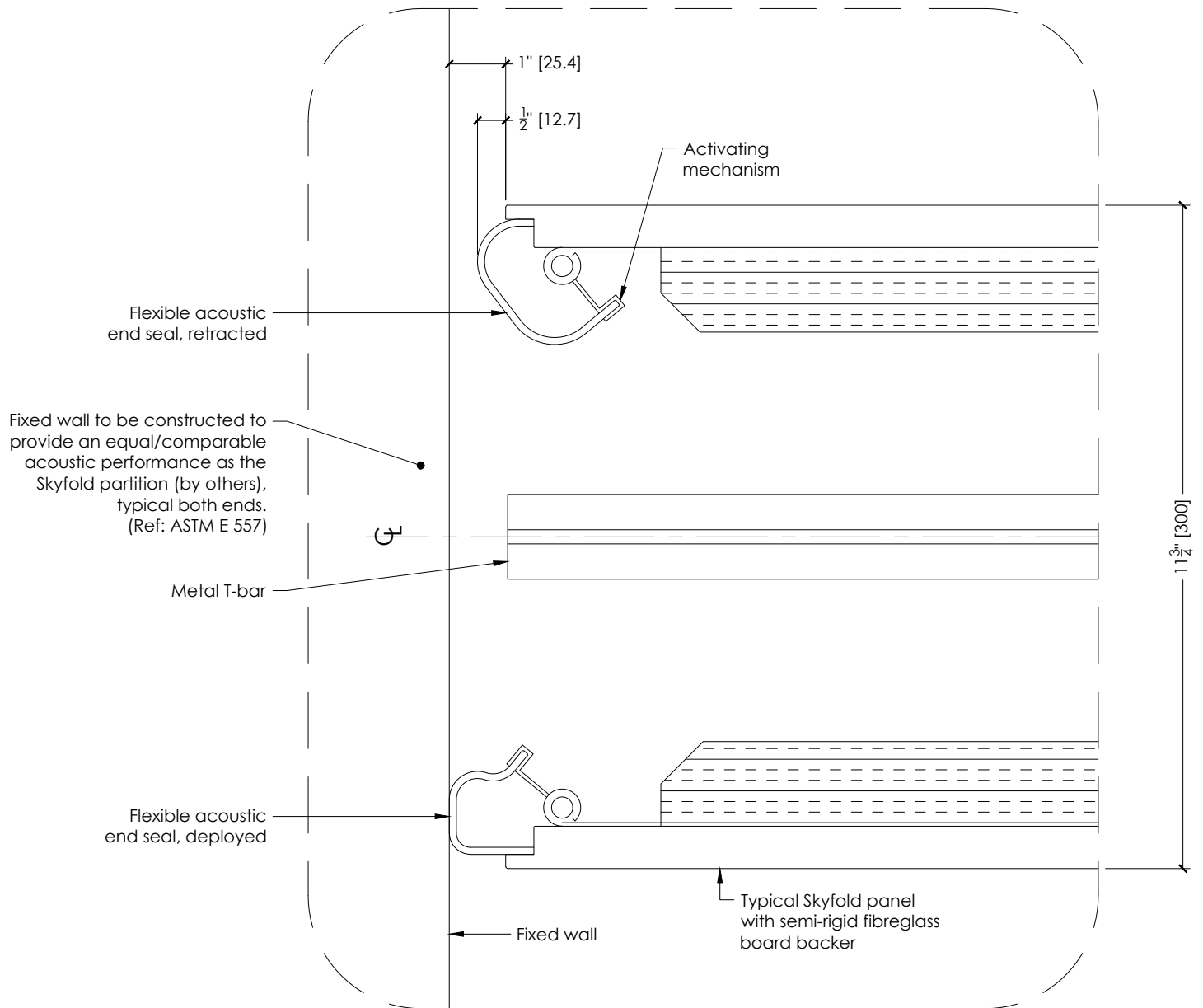

PRELIMINARY:

THIS DRAWING IS INTENDED AS A GUIDE. IN ALL CASES SKYFOLD SHOP DRAWINGS SPECIFIC TO EACH PROJECT ARE REQUIRED FOR FINAL BUILD-TO DIMENSIONS.

SKYFOLD®
CLASSIC™ PREMIUM SERIES

TYPICAL EVEN SKYFOLD WALL
Standard drive unit

END SEAL DETAIL

drawing no.

S7734-5 RO

scale

N.T.S.

© SKYFOLD INC.

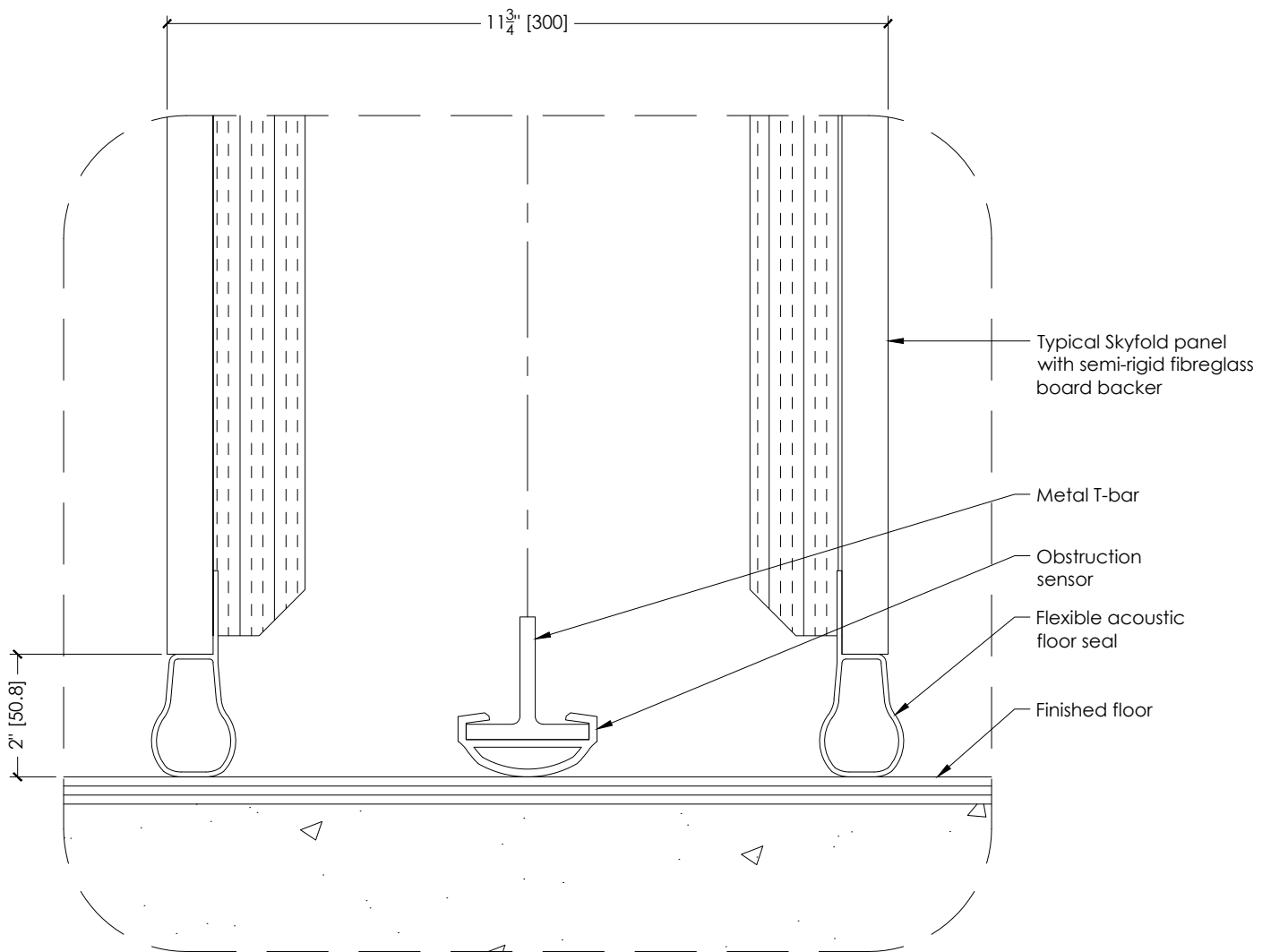

PRELIMINARY:

THIS DRAWING IS INTENDED AS A GUIDE. IN ALL CASES SKYFOLD SHOP DRAWINGS SPECIFIC TO EACH PROJECT ARE REQUIRED FOR FINAL BUILD-TO DIMENSIONS.



TYPICAL EVEN SKYFOLD WALL
Standard drive unit

FLOOR SEAL DETAIL

drawing no. **S7734-6 RO** scale **N.T.S.**