

Fixed wall to be constructed to provide an equal/comparable acoustic performance as the Skyfold partition **(by others)**, typical both ends. (Ref: ASTM E 557)



Continuous support steel** **(by others)**, subject to structural approval.

Drive unit attached to support steel** before construction of acoustic barrier & pocket.

Ø 3/16" [5], 6x31 A/C cables. Lift cable paths must be clear of all mechanical obstructions.

NOTE: ALL SUPPORT STEEL IS BY OTHERS.

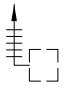
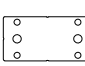
LEGEND

-  Switch control
-  Ceiling support & hanger
-  Ceiling access panel

****SUPPORT STEEL:**
 C-CHANNEL, FLANGES UP, IS THE RECOMMENDED STRUCTURAL ATTACHMENT. (C8X11.5, C200X75, C200X80, OR EQUIVALENT)

NOTE:
 ALTERNATE ATTACHMENT STEEL IS POSSIBLE. MUST BE 6" [150 mm] MINIMUM, TO BE REVIEWED BY SKYFOLD.



TYPICAL PRISMA WALL Compact 90° drive unit

PRELIMINARY:
 THIS DRAWING IS INTENDED AS A GUIDE. IN ALL CASES SKYFOLD SHOP DRAWINGS SPECIFIC TO EACH PROJECT ARE REQUIRED FOR FINAL BUILD-TO DIMENSIONS.

PLAN

drawing no. S7732-1 R0 scale N.T.S.

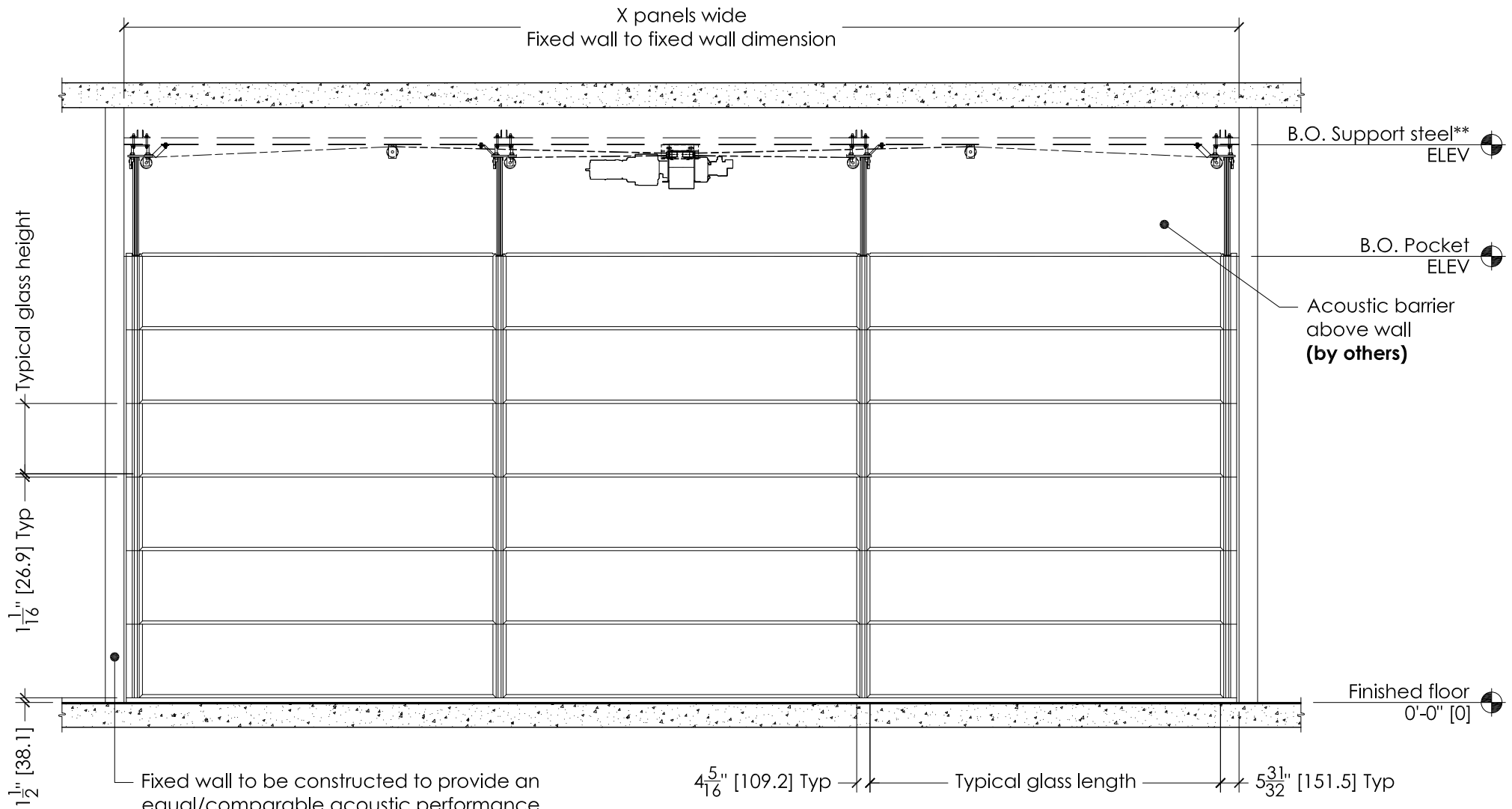

Fixed wall to be constructed to provide an equal/comparable acoustic performance as the Skyfold partition **(by others)**, typical both ends. (Ref: ASTM E 557)

NOTE: ALL SUPPORT STEEL IS BY OTHERS.

NOTE: FINISHED FLOOR $\pm\frac{1}{4}$ " [± 6 mm] FROM FLAT LEVEL
 FIXED WALL $+\frac{1}{4}$ " / -0 " [$+6$ mm / -0 mm] FROM FLAT VERTICAL

PRELIMINARY:
 THIS DRAWING IS INTENDED AS A GUIDE. IN ALL CASES SKYFOLD SHOP DRAWINGS SPECIFIC TO EACH PROJECT ARE REQUIRED FOR FINAL BUILD-TO DIMENSIONS.

****SUPPORT STEEL:**
 C-CHANNEL, FLANGES UP, IS THE RECOMMENDED STRUCTURAL ATTACHMENT. (C8X11.5, C200X75, C200X80, OR EQUIVALENT)
 NOTE:
 ALTERNATE ATTACHMENT STEEL IS POSSIBLE. MUST BE 6" [150 mm] MINIMUM, TO BE REVIEWED BY SKYFOLD.



TYPICAL PRISMA WALL
 Compact 90° drive unit

ELEVATION

drawing no. S7732-2 R0 scale N.T.S.

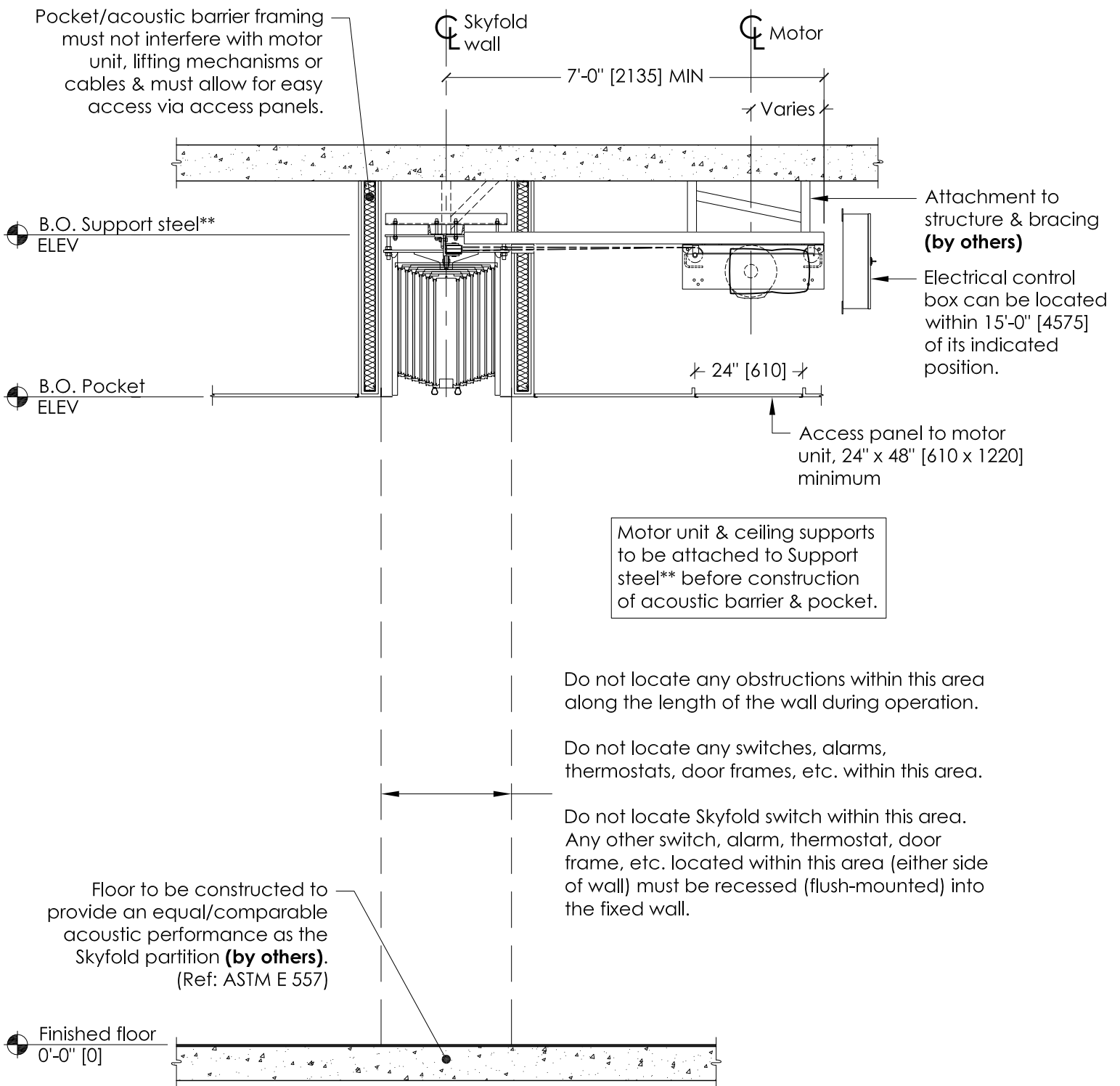

****SUPPORT STEEL:**

C-CHANNEL, FLANGES UP, IS THE RECOMMENDED STRUCTURAL ATTACHMENT. (C8X11.5, C200X75, C200X80, OR EQUIVALENT)

NOTE:
ALTERNATE ATTACHMENT STEEL IS POSSIBLE. MUST BE 6" [150 mm] MINIMUM, TO BE REVIEWED BY SKYFOLD.

PRELIMINARY:

THIS DRAWING IS INTENDED AS A GUIDE. IN ALL CASES SKYFOLD SHOP DRAWINGS SPECIFIC TO EACH PROJECT ARE REQUIRED FOR FINAL BUILD-TO DIMENSIONS.

NOTE: ALL SUPPORT STEEL IS BY OTHERS.



TYPICAL PRISMA WALL
Compact 90° drive unit

SECTION: WALL UP

drawing no.

S7732-3 R0

scale

N.T.S.

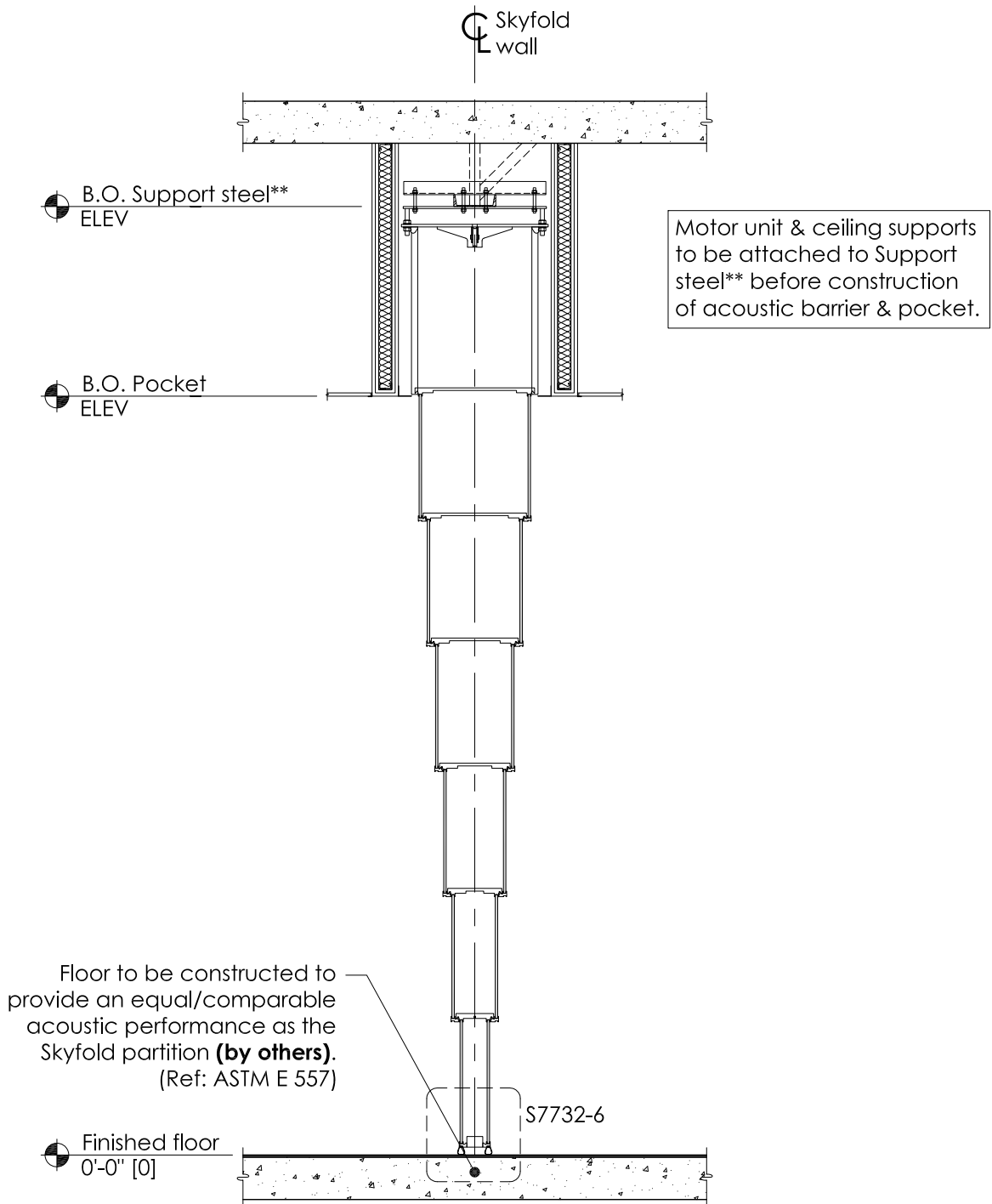

****SUPPORT STEEL:**

C-CHANNEL, FLANGES UP, IS THE RECOMMENDED STRUCTURAL ATTACHMENT. (C8X11.5, C200X75, C200X80, OR EQUIVALENT)

NOTE:
ALTERNATE ATTACHMENT STEEL IS POSSIBLE. MUST BE 6" [150 mm] MINIMUM, TO BE REVIEWED BY SKYFOLD.

PRELIMINARY:

THIS DRAWING IS INTENDED AS A GUIDE. IN ALL CASES SKYFOLD SHOP DRAWINGS SPECIFIC TO EACH PROJECT ARE REQUIRED FOR FINAL BUILD-TO DIMENSIONS.

NOTE: ALL SUPPORT STEEL IS BY OTHERS.



TYPICAL PRISMA WALL
Compact 90° drive unit

SECTION: WALL DOWN

drawing no.

S7732-4 R0

scale

N.T.S.

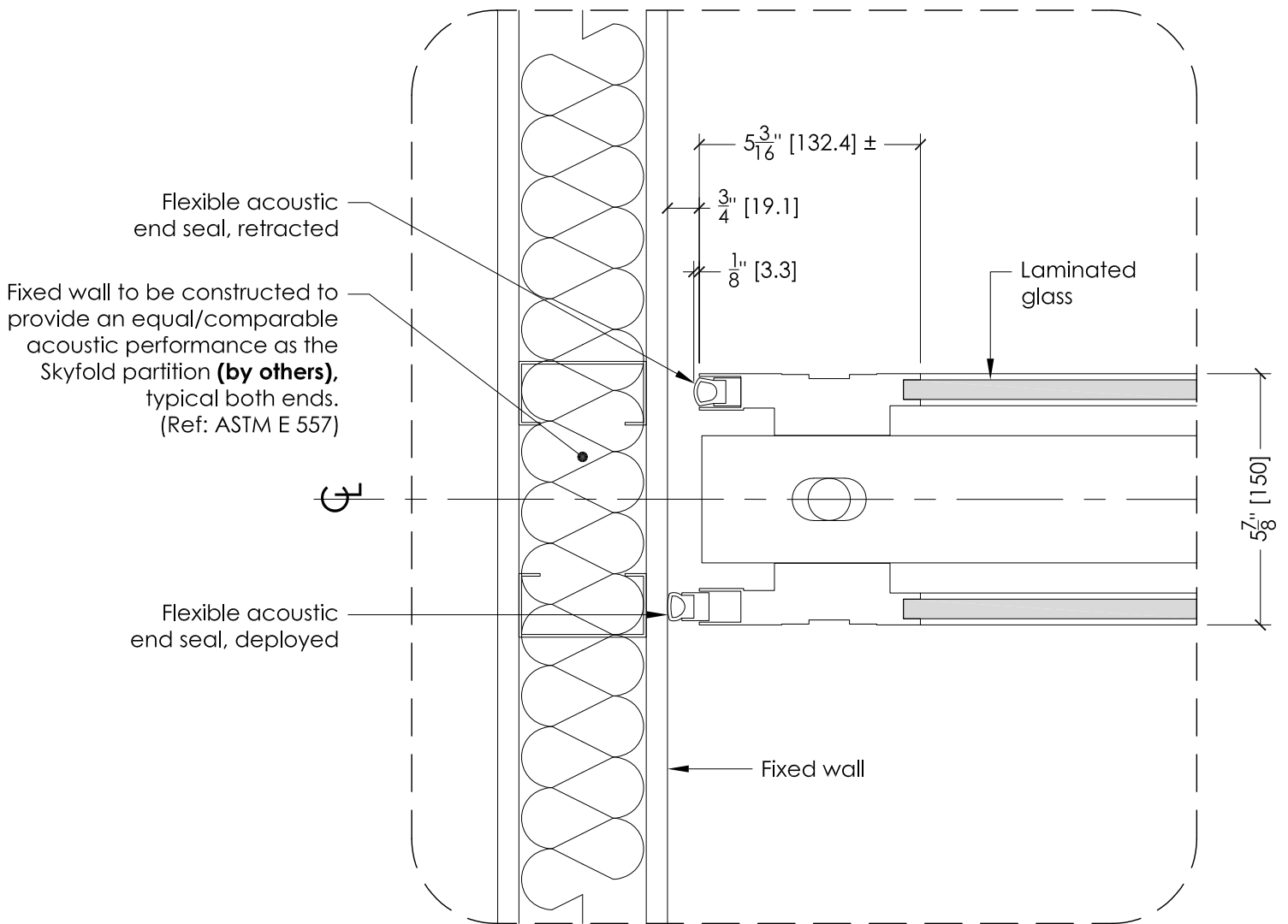

TYPICAL PRISMA WALL
Compact 90° drive unit

END SEAL DETAIL @ BOTTOM PANEL

PRELIMINARY:
THIS DRAWING IS INTENDED AS A GUIDE. IN ALL CASES SKYFOLD SHOP DRAWINGS SPECIFIC TO EACH PROJECT ARE REQUIRED FOR FINAL BUILD-TO DIMENSIONS.

drawing no. S7732-5 R0 scale N.T.S.

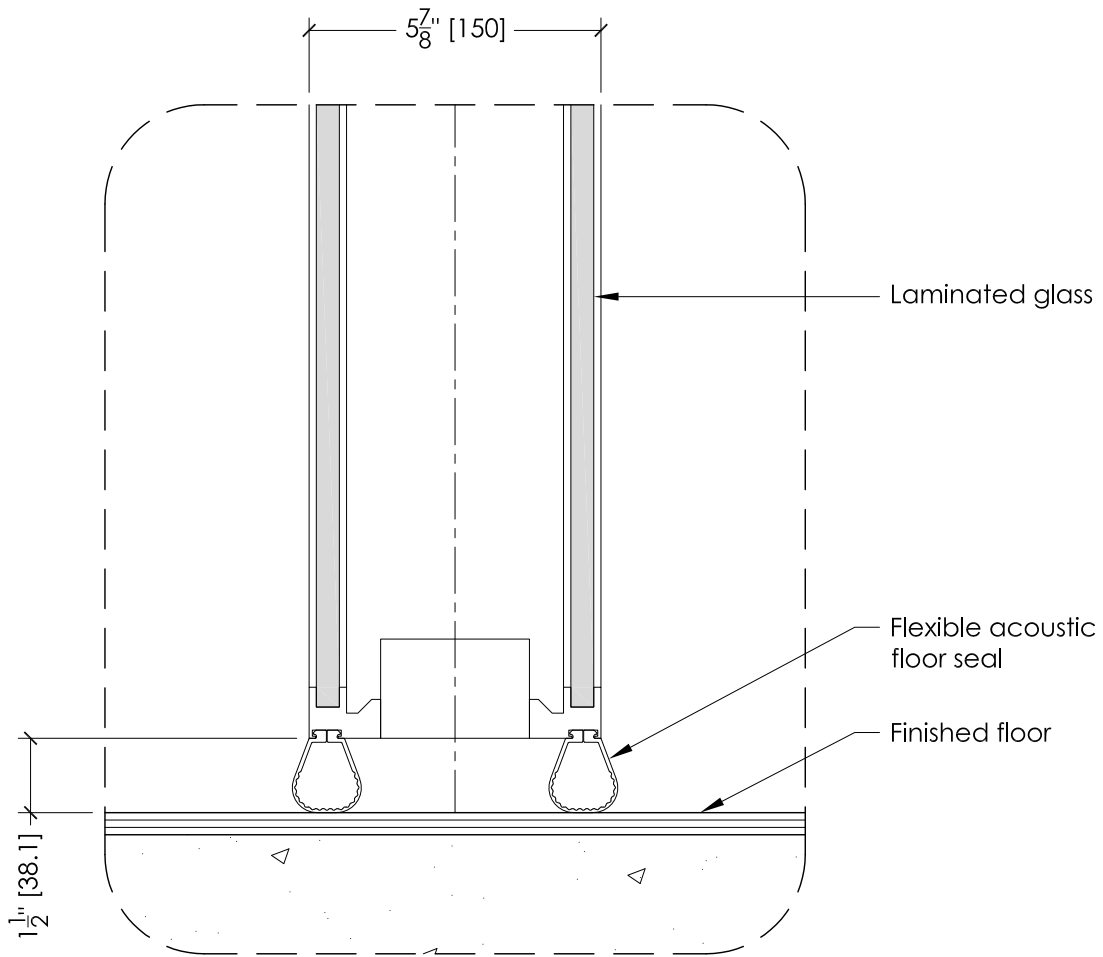

TYPICAL PRISMA WALL
Compact 90° drive unit

FLOOR SEAL DETAIL @ BOTTOM PANEL

drawing no.

scale

S7732-6 R0

N.T.S.

PRELIMINARY:

THIS DRAWING IS INTENDED AS A GUIDE. IN ALL CASES SKYFOLD SHOP DRAWINGS SPECIFIC TO EACH PROJECT ARE REQUIRED FOR FINAL BUILD-TO DIMENSIONS.