

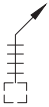

LEGEND

-  KEY SWITCH CONTROL
-  CEILING SUPPORT & HANGER
-  CEILING ACCESS PANEL

NOTE: ALL SUPPORT STEEL IS BY OTHERS.

PRELIMINARY:
THIS DRAWING IS INTENDED AS A GUIDE. IN ALL CASES SKYFOLD SHOP DRAWINGS SPECIFIC TO EACH PROJECT ARE REQUIRED FOR FINAL BUILD-TO DIMENSIONS.

**SUPPORT STEEL:

C-CHANNEL, FLANGES UP, IS THE RECOMMENDED STRUCTURAL ATTACHMENT. (C8X11.5, C200X75, C200X80, OR EQUIVALENT)

NOTE:
ALTERNATE ATTACHMENT STEEL IS POSSIBLE. MUST BE 6" [150 mm] MINIMUM, TO BE REVIEWED BY SKYFOLD.



TYPICAL ODD SKYFOLD WALL
Standard drive unit

PLAN

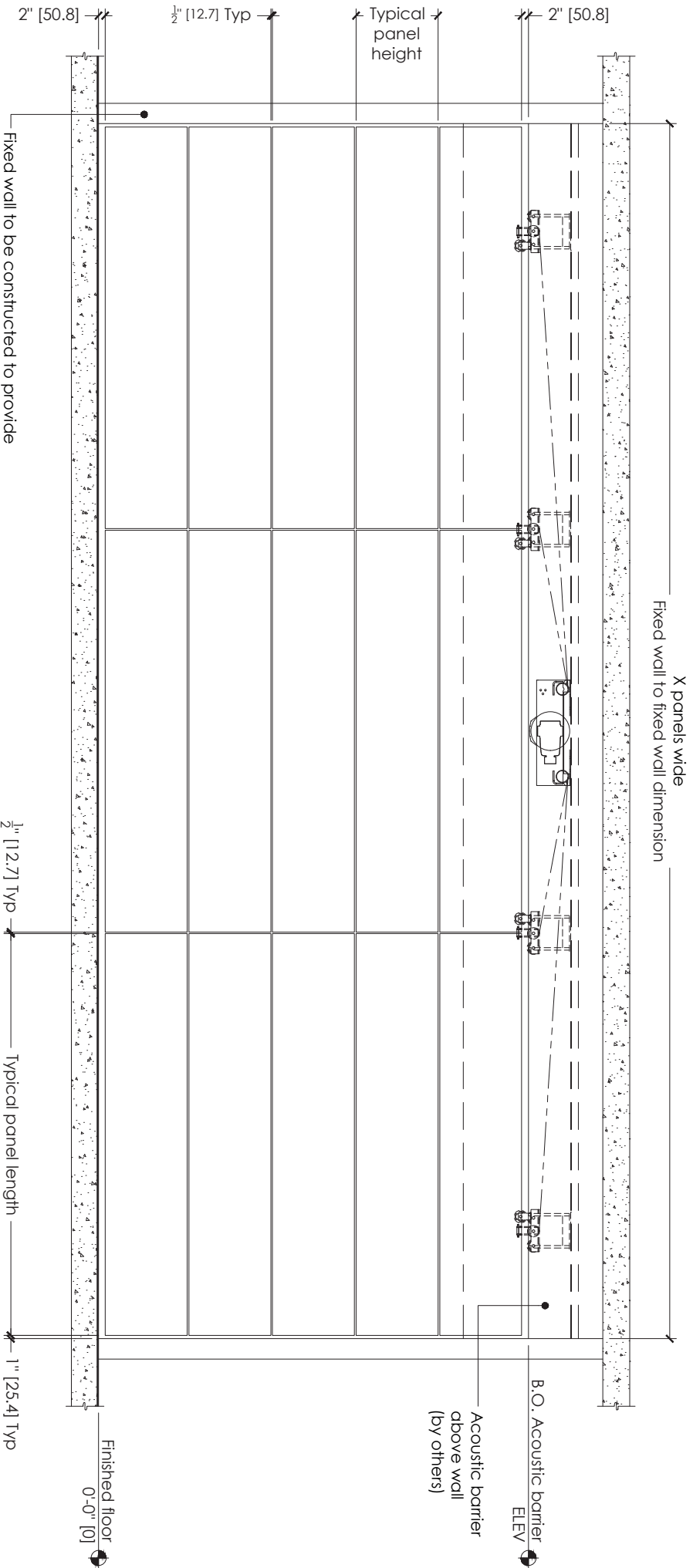

Fixed wall to be constructed to provide an equal/comparable acoustic performance as the Skyfold partition (by others), typical both ends. (Ref: ASTM E 557)

NOTE:
 FINISHED FLOOR +1/4" [+6] / -0 [-0] FROM FLAT LEVEL
 FIXED WALL +1/4" [+6] / -0 [-0] FROM FLAT LEVEL

NOTE: ALL SUPPORT STEEL IS BY OTHERS.

PRELIMINARY:
 THIS DRAWING IS INTENDED AS A GUIDE. IN ALL CASES SKYFOLD SHOP DRAWINGS SPECIFIC TO EACH PROJECT ARE REQUIRED FOR FINAL BUILD-TO DIMENSIONS.

****SUPPORT STEEL:**
 C-CHANNEL, FLANGERS UP, IS THE RECOMMENDED STRUCTURAL ATTACHMENT. (C8X11.5, C200X75, C200X80, OR EQUIVALENT)

NOTE:
 ALTERNATE ATTACHMENT STEEL IS POSSIBLE. MUST BE 6" [150mm] MINIMUM, TO BE REVIEWED BY SKYFOLD.



TYPICAL ODD SKYFOLD WALL
 Standard drive unit

ELEVATION

drawing no. **S6568-2 R1** scale N.T.S.

Standard motor unit & ceiling supports to be attached to Support steel** before construction of acoustic barrier & pocket.

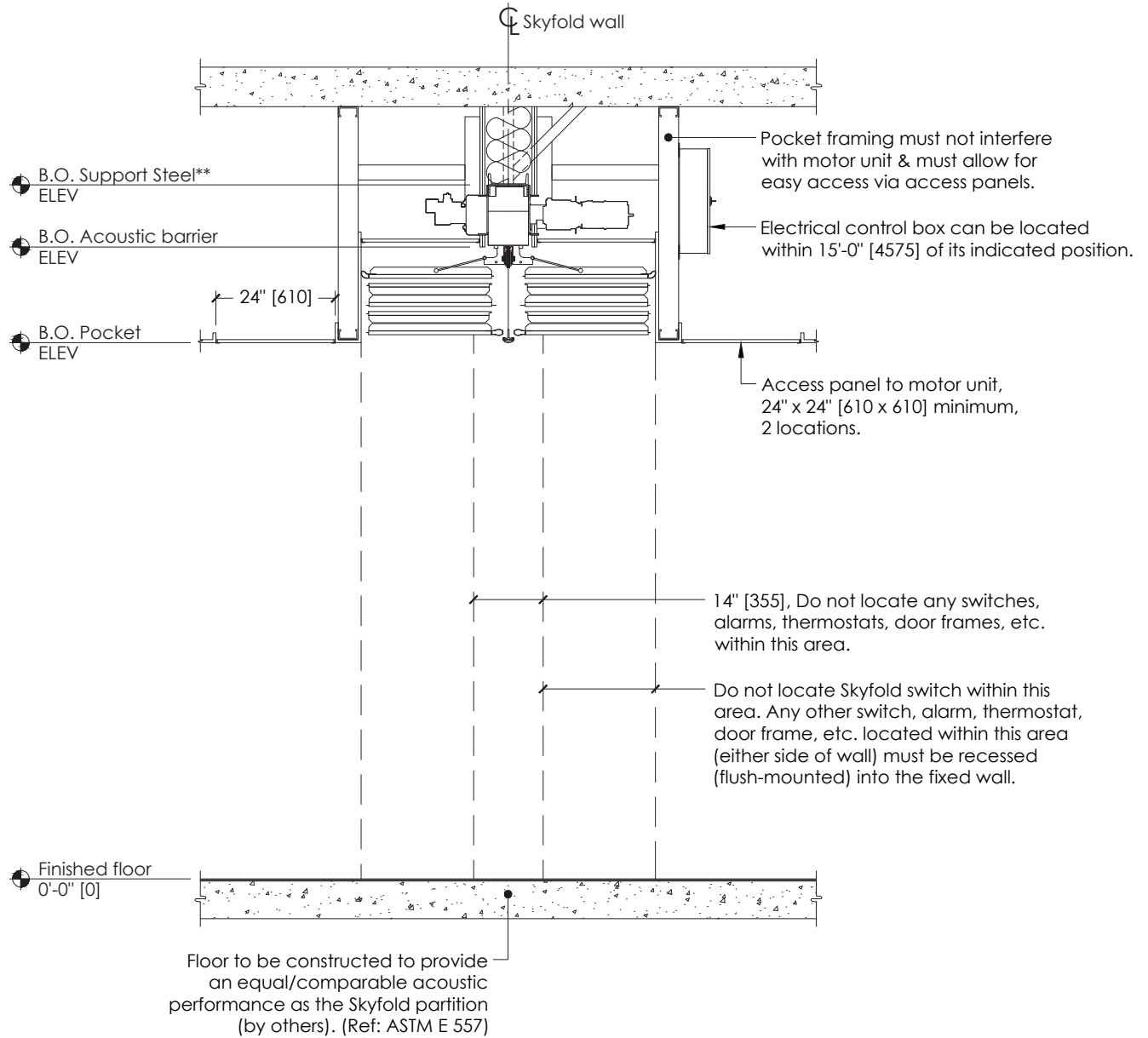

****SUPPORT STEEL:**

C-CHANNEL, FLANGES UP, IS THE RECOMMENDED STRUCTURAL ATTACHMENT. (C8X11.5, C200X75, C200X80, OR EQUIVALENT)

NOTE: ALTERNATE ATTACHMENT STEEL IS POSSIBLE. MUST BE 6" [150 mm] MINIMUM, TO BE REVIEWED BY SKYFOLD.

NOTE: ALL SUPPORT STEEL IS BY OTHERS.

PRELIMINARY:

THIS DRAWING IS INTENDED AS A GUIDE. IN ALL CASES SKYFOLD SHOP DRAWINGS SPECIFIC TO EACH PROJECT ARE REQUIRED FOR FINAL BUILD-TO DIMENSIONS.



TYPICAL ODD SKYFOLD WALL
Standard drive unit

SECTION: WALL UP

drawing no. **S6568-3 R1** scale N.T.S.

Standard motor unit & ceiling supports to be attached to Support steel** before construction of acoustic barrier & pocket.

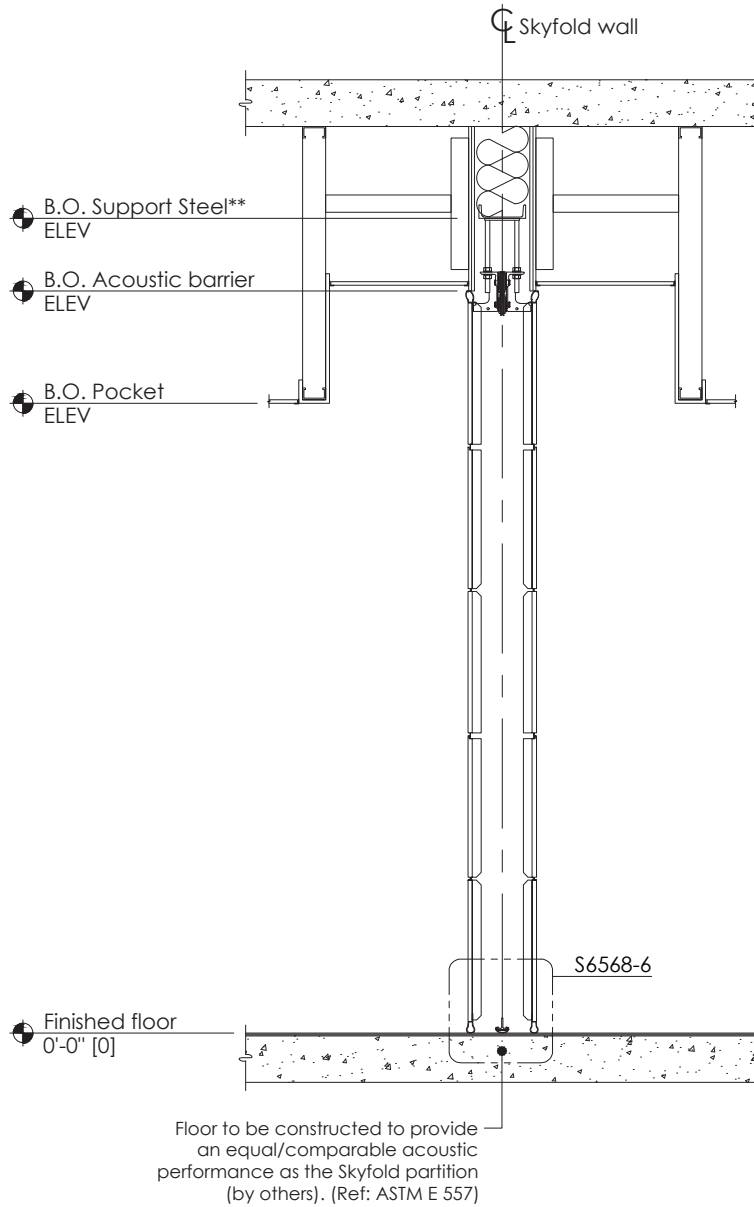

****SUPPORT STEEL:**

C-CHANNEL, FLANGES UP, IS THE RECOMMENDED STRUCTURAL ATTACHMENT. (C8X11.5, C200X75, C200X80, OR EQUIVALENT)

NOTE:
ALTERNATE ATTACHMENT STEEL IS POSSIBLE. MUST BE 6" [150 mm] MINIMUM, TO BE REVIEWED BY SKYFOLD.

NOTE: ALL SUPPORT STEEL IS BY OTHERS.

PRELIMINARY:

THIS DRAWING IS INTENDED AS A GUIDE. IN ALL CASES SKYFOLD SHOP DRAWINGS SPECIFIC TO EACH PROJECT ARE REQUIRED FOR FINAL BUILD-TO DIMENSIONS.



TYPICAL ODD SKYFOLD WALL
Standard drive unit

SECTION: WALL DOWN

drawing no. **S6568-4 R1** scale **N.T.S.**

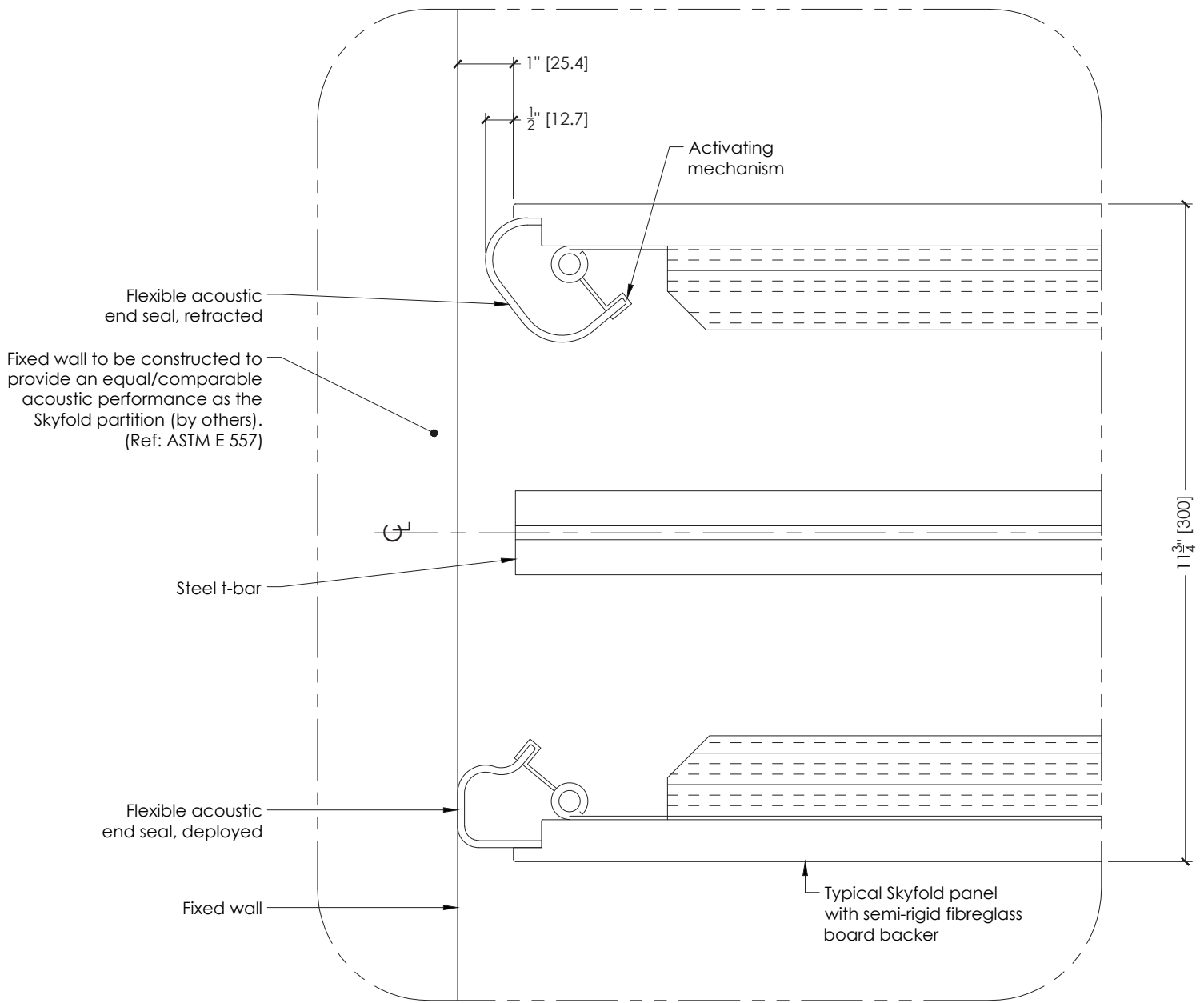

PRELIMINARY:

THIS DRAWING IS INTENDED AS A GUIDE. IN ALL CASES SKYFOLD SHOP DRAWINGS SPECIFIC TO EACH PROJECT ARE REQUIRED FOR FINAL BUILD-TO DIMENSIONS.



TYPICAL ODD SKYFOLD WALL
Standard drive unit

END SEAL DETAIL

drawing no. **S6568-5 R1** scale **N.T.S.**

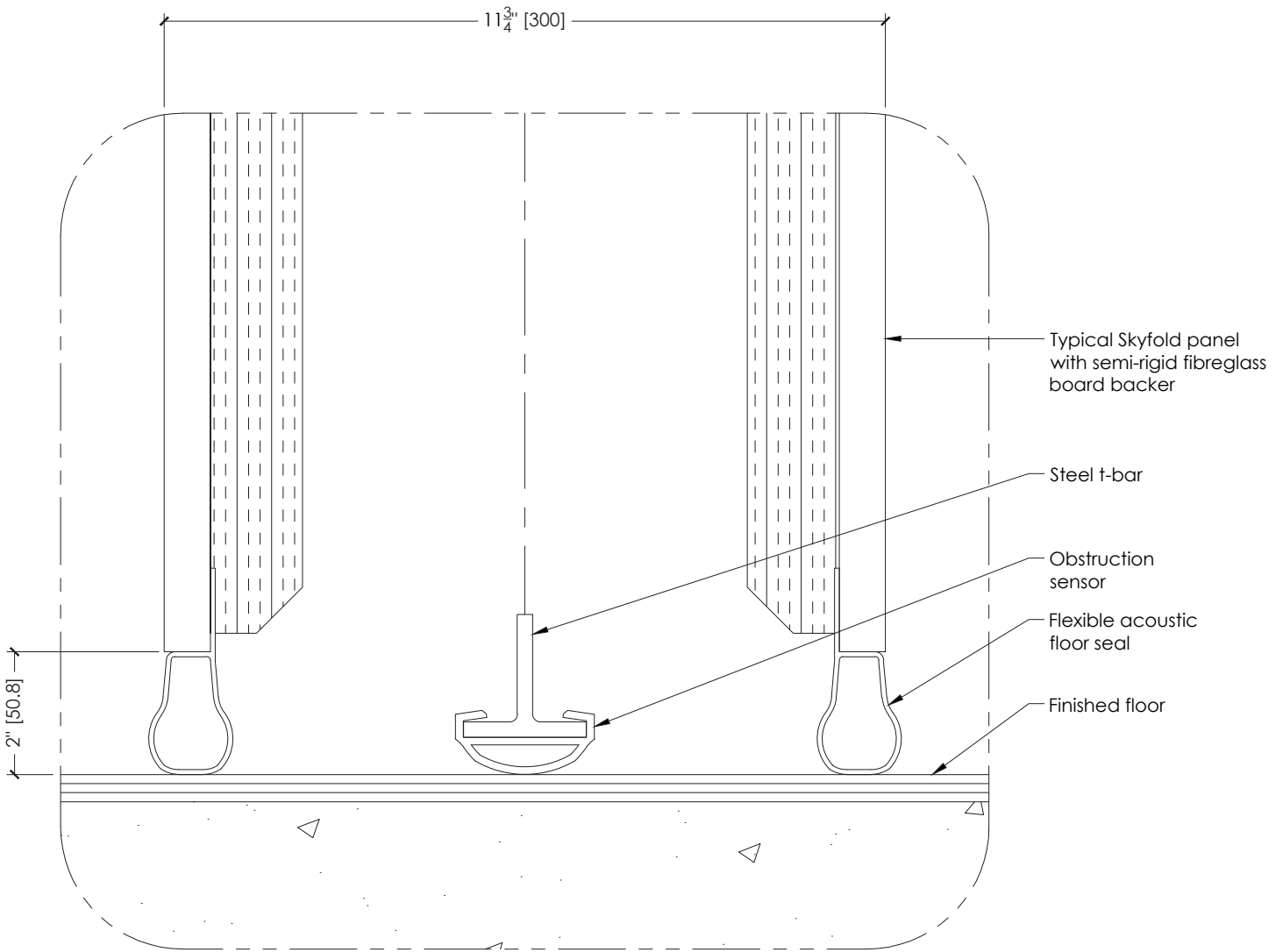

PRELIMINARY:

THIS DRAWING IS INTENDED AS A GUIDE. IN ALL CASES SKYFOLD SHOP DRAWINGS SPECIFIC TO EACH PROJECT ARE REQUIRED FOR FINAL BUILD-TO DIMENSIONS.



TYPICAL ODD SKYFOLD WALL
Standard drive unit

FLOOR SEAL DETAIL

drawing no. scale
S6568-6 R1 N.T.S.